

適用B,BXベルト

Unit : mm

品番 Part No.	デーラム径 dn	外径 D	下穴径 ds	最大軸穴径 Max.Bore	ボス部 Hub				リム幅 W	質量 (kg)	形状図番 Type
					d	t1	t2	l			
3	65.2	76.2	13	28			26	38	64	1.3	④-1
			13	28	50	19	45	38	64		②-1
3 1/2	77.9	88.9	13	30			26	38	64	1.7	④-1
			13	28	50	19	45	38	64		②-1
4	90.6	101.6	15	35			26	38	64	2.1	④-1
			15	32	57	19	45	38	64		②-1
4 1/2	103.3	114.3	15	40			26	38	64	2.5	④-1
			15	35	60	19	45	38	64		②-1
5	116.0	127.0	15	50			26	38	64	3.0	④-1
			15	35	64	19	45	38	64		②-1
5 1/2	128.7	139.7	15	55			26	38	64	3.6	④-1
			15	40	70	19	45	38	64		②-1
6	141.4	152.4	15	40	70	10	10	44	64	3.6	⑤-2
6 1/2	154.1	165.1	15	40	70	10	10	44	64	3.9	⑤-2
7	166.8	177.8	20	42	76	10	10	44	64	4.5	⑤-2
8	192.2	203.2	20	42	76	10	10	44	64	5.2	⑤-2
9	217.6	228.6	20	42	76	10	10	44	64	5.3	⑤-2
10	243.0	254.0	20	42	76	10	10	44	64	6.1	⑤-2
11	268.4	279.4	20	42	76	10	10	44	64	6.4	⑤-2
12	293.8	304.8	20	45	83	10	10	44	64	7.4	⑤-2
13	319.2	330.2	22	45	83	10	10	44	64	7.7	⑤-2
14	344.6	355.6	22	45	83	10	10	44	64	8.9	⑤-2
15	370.0	381.0	22	50	89	7	7	50	64	9.8	⑤-2
16	395.4	406.4	22	50	89	7	7	50	64	10.8	⑤-2
18	446.2	457.2	22	50	89	7	7	50	64	13.0	⑤-2
20	497.0	508.0	22	50	89	7	7	50	64	15.0	⑤-2
22	547.8	558.8	22	52	95	7	7	50	64	17.2	⑤-2
24	598.6	609.6	22	52	95	7	7	50	64	18.0	⑤-2
26	649.4	660.4	22	56	102	4	4	56	64	21.0	⑤-2
28	700.2	711.2	22	56	102	4	4	56	64	24.0	⑤-2

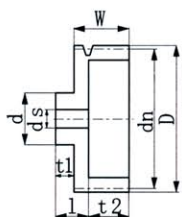

②-1

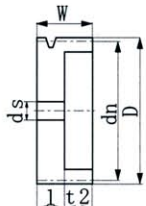

④-1

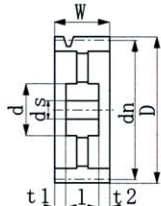

⑤-2